

FOR SALE

# RIVERSIDE BUSINESS PARK

1211 BELMAR DRIVE  
ABERDEEN, MARYLAND 21001



<b>BUILDING SIZE:</b>	70,563± SF
<b>SITE SIZE:</b>	6.21± Acres
<b>YEAR BUILT:</b>	1988
<b>CONSTRUCTION TYPE:</b>	Masonry/Metal
<b>CEILING HEIGHT:</b>	24' Clear
<b>COLUMN SPACING:</b>	Varies
<b>LOADING:</b>	5 Docks, 1 Drive-in + 3 Rail Doors
<b>HEATING:</b>	Gas fired
<b>LIGHTING:</b>	Metal Halide
<b>SPRINKLER:</b>	Wet system
<b>ZONING:</b>	G1
<b>COMMENTS:</b>	Rail Served/CSX Power - Ample Air-Conditioned Warehouse



FOR MORE  
INFORMATION  
PLEASE  
CONTACT

**Bill Pellington**  
Senior Vice President  
410.244.3137  
bill.pellington@cbre.com

**Justin Mohler**  
Vice President  
410.244.3116  
justin.mohler@cbre.com

**Adam Weidner**  
Senior Associate  
410.244.3197  
adam.weidner@cbre.com

**Toby Mink**  
Senior Associate  
410.244.3171  
toby.mink@cbre.com

**CBRE**  
CB RICHARD ELLIS

FOR SALE

# RIVERSIDE BUSINESS PARK



1211 BELMAR DRIVE  
ABERDEEN, MARYLAND 21001

## ACCESSIBILITY

I-95:	11 mins
Port of Baltimore:	29 mins
BWI Airport:	42 mins
Philadelphia, PA:	1 hr 20 mins
Washington, DC:	1 hr 17 mins
New York City:	2 hrs 35 mins

## REGIONAL MAP

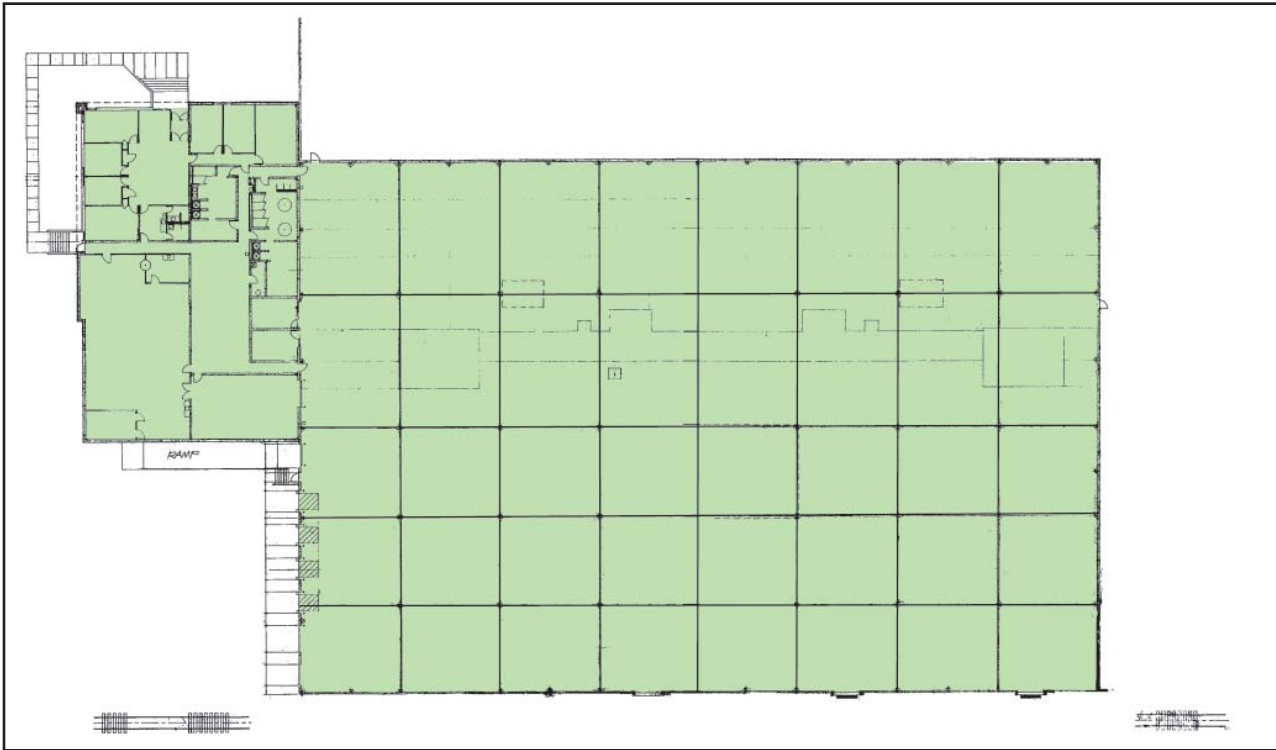
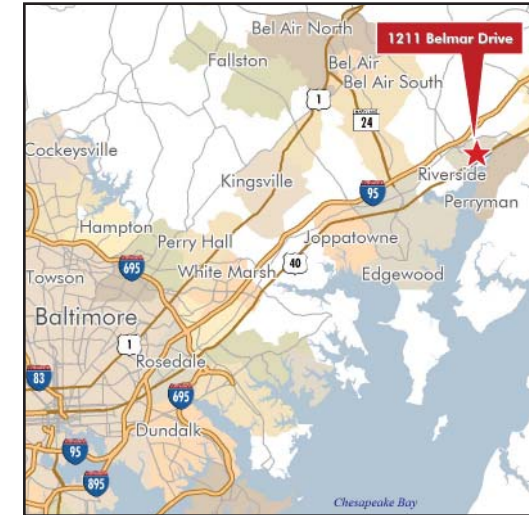

## LOCAL MAP



FOR MORE  
INFORMATION  
PLEASE  
CONTACT

### Bill Pellington

Senior Vice President

410.244.3137

bill.pellington@cbre.com

### Justin Mohler

Vice President

410.244.3116

justin.mohler@cbre.com

### Adam Weidner

Senior Associate

410.244.3197

adam.weidner@cbre.com

### Toby Mink

Senior Associate

410.244.3171

toby.mink@cbre.com

CB Richard Ellis | 250 West Pratt Street | Suite 1700 | Baltimore, MD 21201 | [www.cbre.com/baltimore](http://www.cbre.com/baltimore)

©2009 CB Richard Ellis, Inc. The information above has been obtained from sources believed reliable. While we do not doubt its accuracy, we have not verified it and make no guarantee, warranty or representation about it. It is your responsibility to independently confirm its accuracy and completeness.

**CBRE**  
CB RICHARD ELLIS